



POWERED BY VIVE WAVE  
CONTENT BY VIVEPORT

Get started

## VIVE Focus Plus

A professional-grade, portable VR solution for enterprise applications, the VIVE Focus™ Plus is designed for easy deployment and management.

### **Compelling VR Experience**

An immersive and interactive world built by an inside-out 6DoF headset and intuitive 6DoF controllers.

### **Enhanced VR Visuals**

Users will be able to see even more details in excellent clarity with reduced ring effects thanks to all-new lenses.

### **Comfort for Extended Usage**

More balanced, more comfortable, and rests easier on users' heads than its predecessor, laying the groundwork for extended, productive sessions in VR.

### **Full VIVE Enterprise Platform Support**

VIVE Enterprise provides professionals with tools to set up, monitor, and manage VIVE devices deployed in multiple locations.

## Check what's inside the box

You will see:



Headset



Controller  
(x2)



Wrist strap  
(x2)



AAA alkaline  
Battery (x4) for  
controllers



USB Type-C  
cable

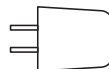

HTC Rapid  
Charger 3.0

## Safety comes first

- Use the VIVE Focus Plus in **a clear and safe area (at least 2m x 2m) that is indoors.**
- Take a break if you experience discomfort or if the headset gets too hot.
- Attach a wrist strap to each controller and wear the wrist strap when using the controller. Using the wrist strap may help prevent the controller from accidentally being dropped; however, do not fling or violently throw the controller because the wrist strap may break.
- Check the Safety Guide for other warnings and instructions.

# Headset

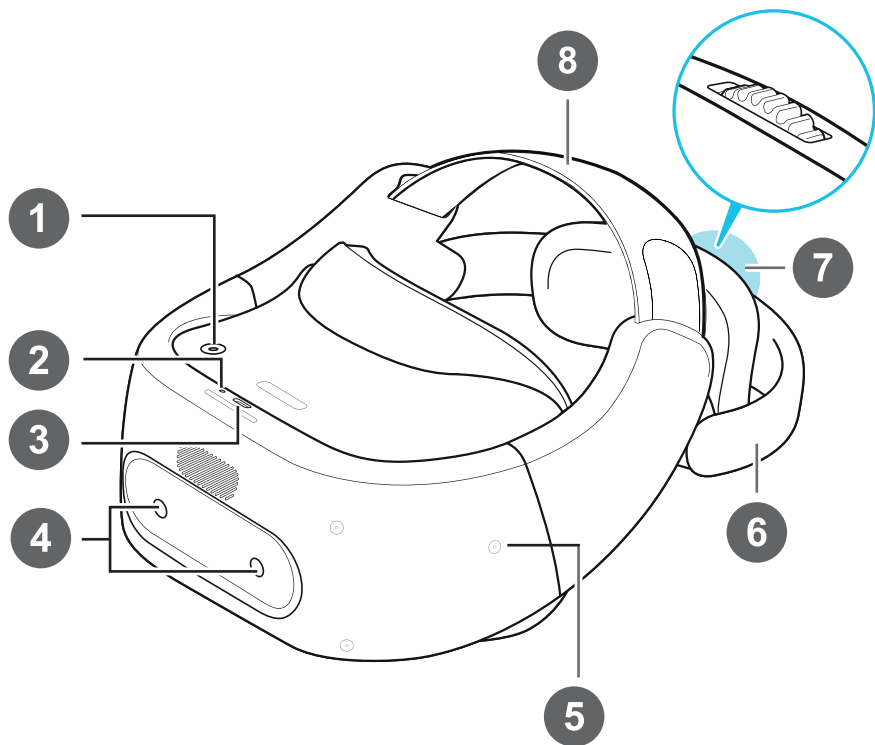

- ① Power button
- ② LED (status light)
- ③ USB Type-C connector
- ④ Dual cameras
- ⑤ Tracking sensor
- ⑥ Back head support
- ⑦ Adjustment dial
- ⑧ Adjustable head strap

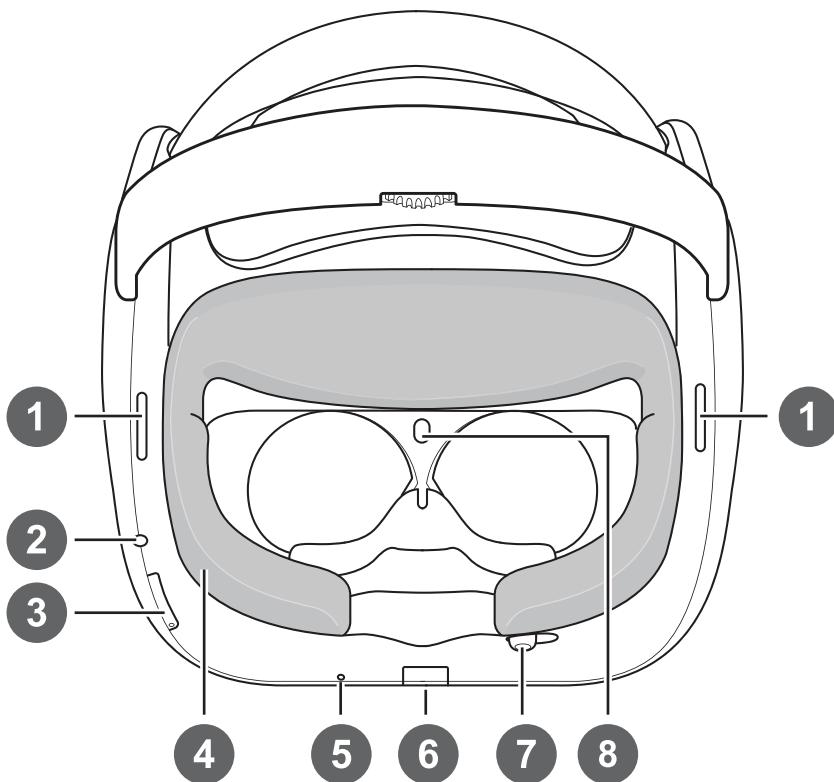

- 1 Speakers
- 2 3.5mm headset jack
- 3 Volume buttons
- 4 Face cushion (replaceable)
- 5 Microphone
- 6 Storage card slot
- 7 IPD adjustment slider  
(Adjust the IPD to get a clear and sharp view. See page 11 for details.)
- 8 Proximity sensor

# Controller

Use the controllers to interact with objects inside VR.

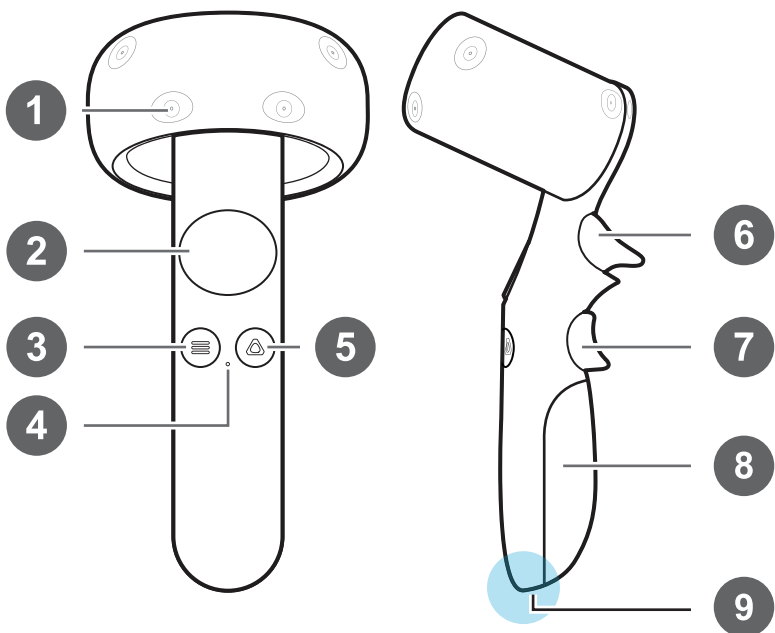

- 1 Tracking sensor
- 2 Trackpad
- 3 Menu button
- 4 Status light
- 5 VIVE button
- 6 Trigger
- 7 Grip button
- 8 Battery compartment
- 9 Wrist strap hole

Remember to put two AAA alkaline batteries (included in the box) inside each controller's battery compartment.

## Attaching the face cushion to the headset

Before using the VIVE Focus Plus headset, make sure the face cushion is attached to the headset.

Insert the central tab on the face cushion into the slot on the headset and align the other face cushion tabs to the remaining slots on the headset frame.

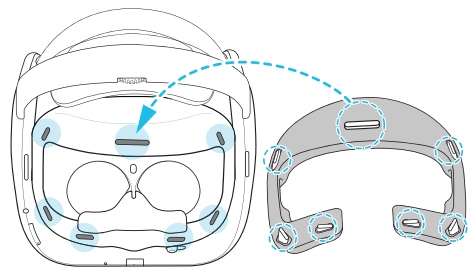

With your thumbs, press these areas on the face cushion.

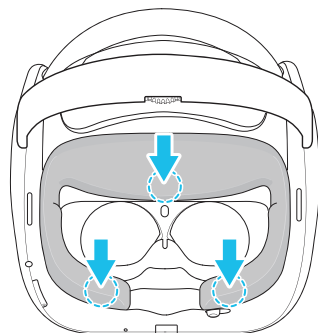

Hold the headset, similar to the illustration, and then press down on the marked areas on the face cushion until you hear a soft click to lock the face cushion to the headset.

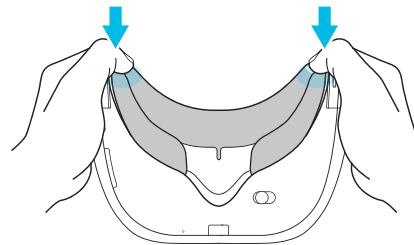

## Sign up for a VIVEPORT account

You will need a VIVEPORT account to log in to VIVEPORT. On your computer's web browser, go to **focus.viveport.com** and sign up using your email address or mobile phone number.

### 1 Turn on the headset

Charge the headset for around 2.5 hours (or until the LED turns white) using the USB Type-C cable and power adapter included in the box. After charging, press and hold the Power button for a few seconds to turn on the headset. Before putting on the headset, make sure you remove the protective films covering the tracking sensors and headset lenses.

Connect to the Internet to access apps from VIVEPORT.

Make sure to have the controllers nearby (with batteries inserted) where you can easily pick them up.

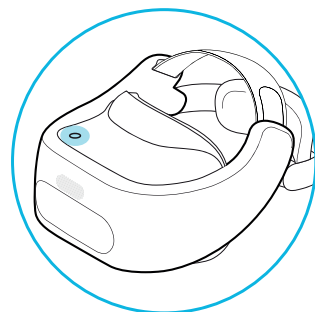



## 2 Wear the headset

- Loosen the velcro straps on top.
- Loosen the back head support using the Adjustment dial. **Do not loosen the support by just pulling it.**

**Note:** If you have long hair or a ponytail, loosen the back head support all the way.

- With the headset on, pull down the back head support and position it at the base of your skull.

**Note:** If you have long hair, position the back head support above the base of your skull (see illustration).

- Tighten the Velcro straps and Adjustment dial until you find your preferred fit. **Do not** push to tighten the back head support.
- The fit should be snug.

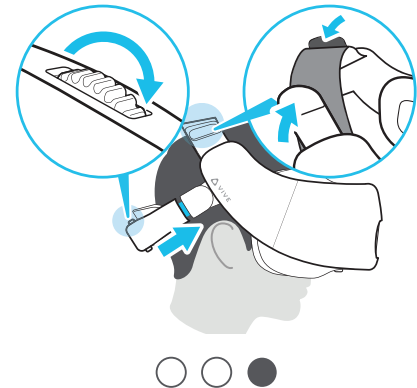
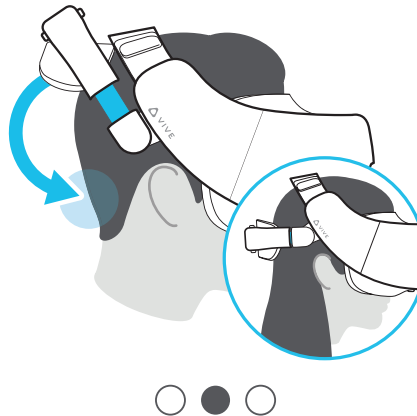
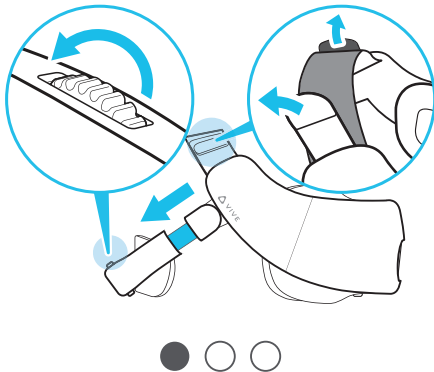

### 3 Pick up the controllers

Hold each controller the same way as the illustration with your index finger on the Trigger and middle finger on the Grip button. Always wear the wrist strap when using the controllers.

In VR, select buttons and objects by using the controller with the beam or by touching them with the controller.

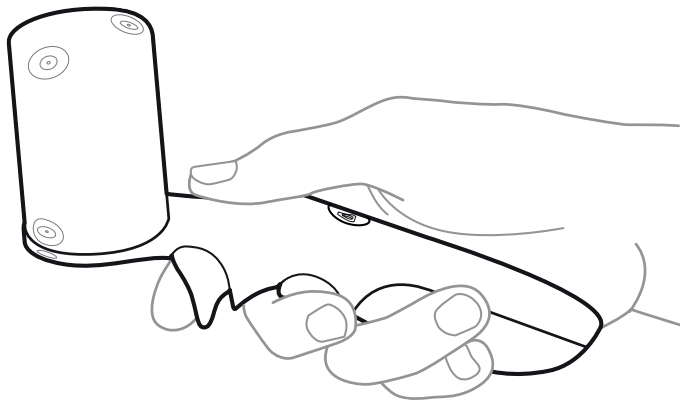

### 4 Inside the headset

You will need to do the following to fully complete the setup of your VIVE Focus Plus:

#### A. Pair the controllers with the headset

Press and hold the VIVE button on both controllers for a few seconds to turn them on and start the pairing process. The pairing is successful when the controllers vibrate for a few seconds. After pairing, follow the onscreen instructions to finish setting up VIVE Focus Plus.

## B. Adjust the IPD

Interpupillary distance (IPD) is the distance between the center of the pupils in your eyes. Setting it to the correct distance is one of the keys to having a great viewing experience in VR.

Follow the guide to learn how to set the IPD properly and position the headset correctly on your face. If you need to adjust the IPD in the future, just move the adjustment slider below the headset.

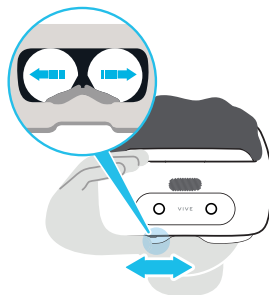

## C. Learn about the controllers

Follow a simple tutorial to familiarize yourself with the controllers. The headset will walk you through the uses of the buttons on the controllers.

## D. Connect the headset to a wireless network

Scroll through the list of available wireless networks by swiping up or down on the controller Trackpad. Select the wireless network by pointing the controller at the wireless network name and then pressing the Trackpad. Select **More** if you don't see your wireless network in the list.

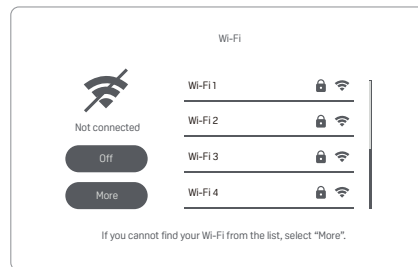

## E. Sign in to VIVEPORT

By signing in to VIVEPORT, you get access to a library of apps that you can download for free or purchase.

## Quick Menu

Open the Quick Menu to change headset settings, access VIVEPORT, go to VIVE Home, check apps that you've downloaded or purchased, and more. While in VR, you can press the VIVE button on the controller anytime to call up the Quick Menu.

To close the Quick Menu, press the VIVE button again.



Go to VIVE Home.



Show all the apps you have downloaded, purchased, and installed.



Change VIVE Focus Plus settings.



Browse VIVEPORT for apps and experiences.



Sign in or check your VIVEPORT account. You can also set up your pay password.

## Audio makes a difference

Listen using the built-in speakers or for a more immersive experience, plug in your own pair of headphones. Press the Volume buttons on the bottom left side of the headset or the right side of the controller to adjust the volume.

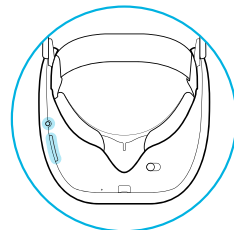

## Product care

Follow these tips to properly care for your VIVE Focus Plus.

- Keep the headset lenses away from sharp objects, including cable tips. This will prevent the headset lenses from being scratched.
- When not in use, store the headset with the lenses pointed away from direct sunlight. Failure to do so may damage the headset display.
- When cleaning the lenses, use a cleaning cloth and moisten it with alcohol or lens cleaner. Wipe in a circular motion from the center to the outer edges of the lenses. Do not scratch the lenses or disassemble other parts of the headset.
- To clean the face cushion, dampen a clean smooth cloth with cold water or diluted alcohol and gently wipe the area you want to clean, and allow the cleaned area to dry.

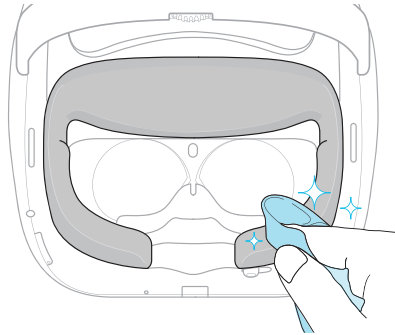

© 2019 HTC Corporation. All rights reserved. VIVE, the VIVE logo, VIVE Focus, VIVE Focus logo, and VIVEPORT are trademarks of HTC Corporation.

[www.vive.com](http://www.vive.com)



91H0xxxx-xxM Rev.A